

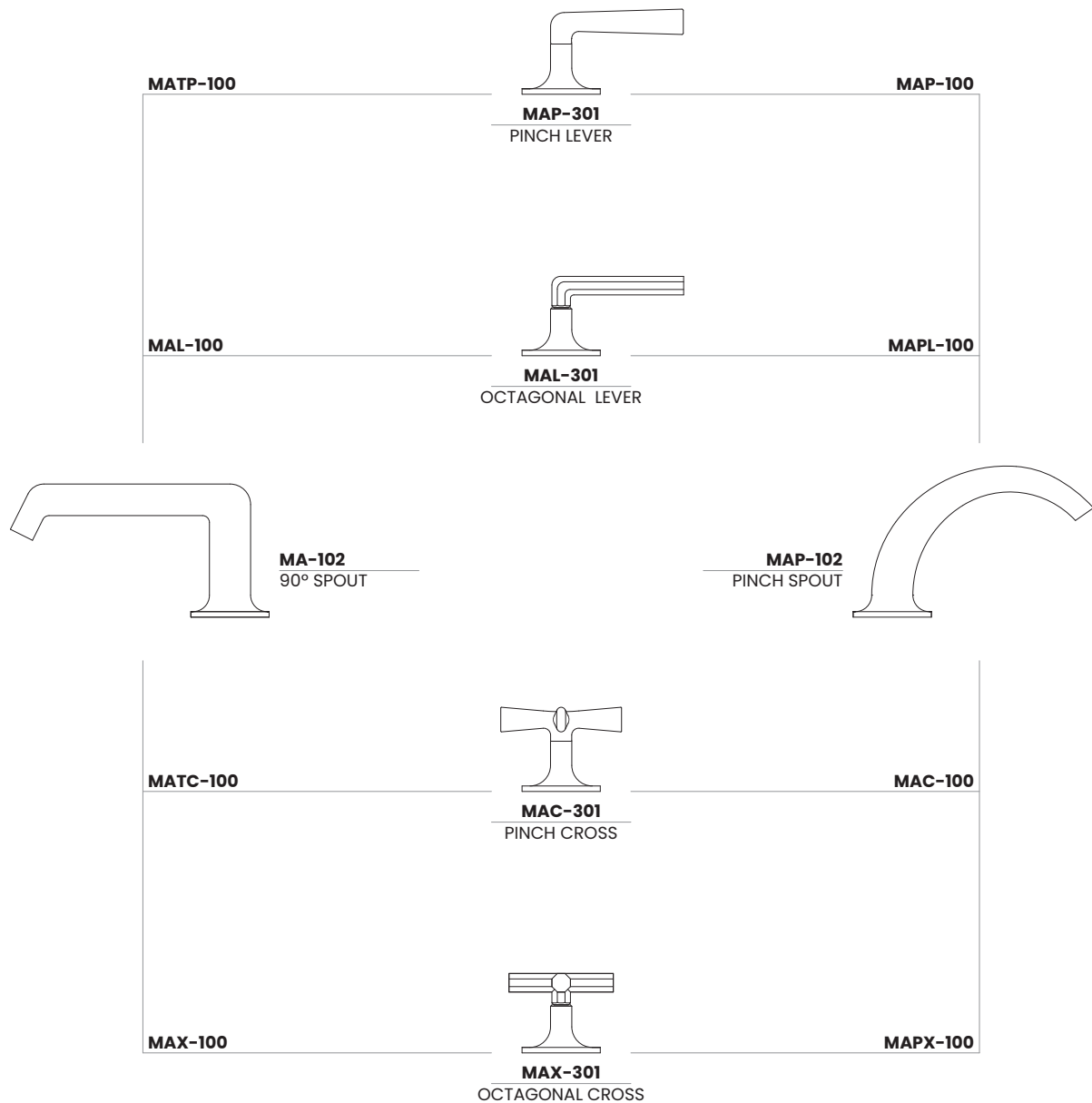

**MA-100 DECK MOUNTED 3-HOLE LAV FAUCET**  
Spout—Handle Combinations





**MA-100 DECK MOUNTED 3-HOLE LAV FAUCET**  
Exploded Parts Diagram

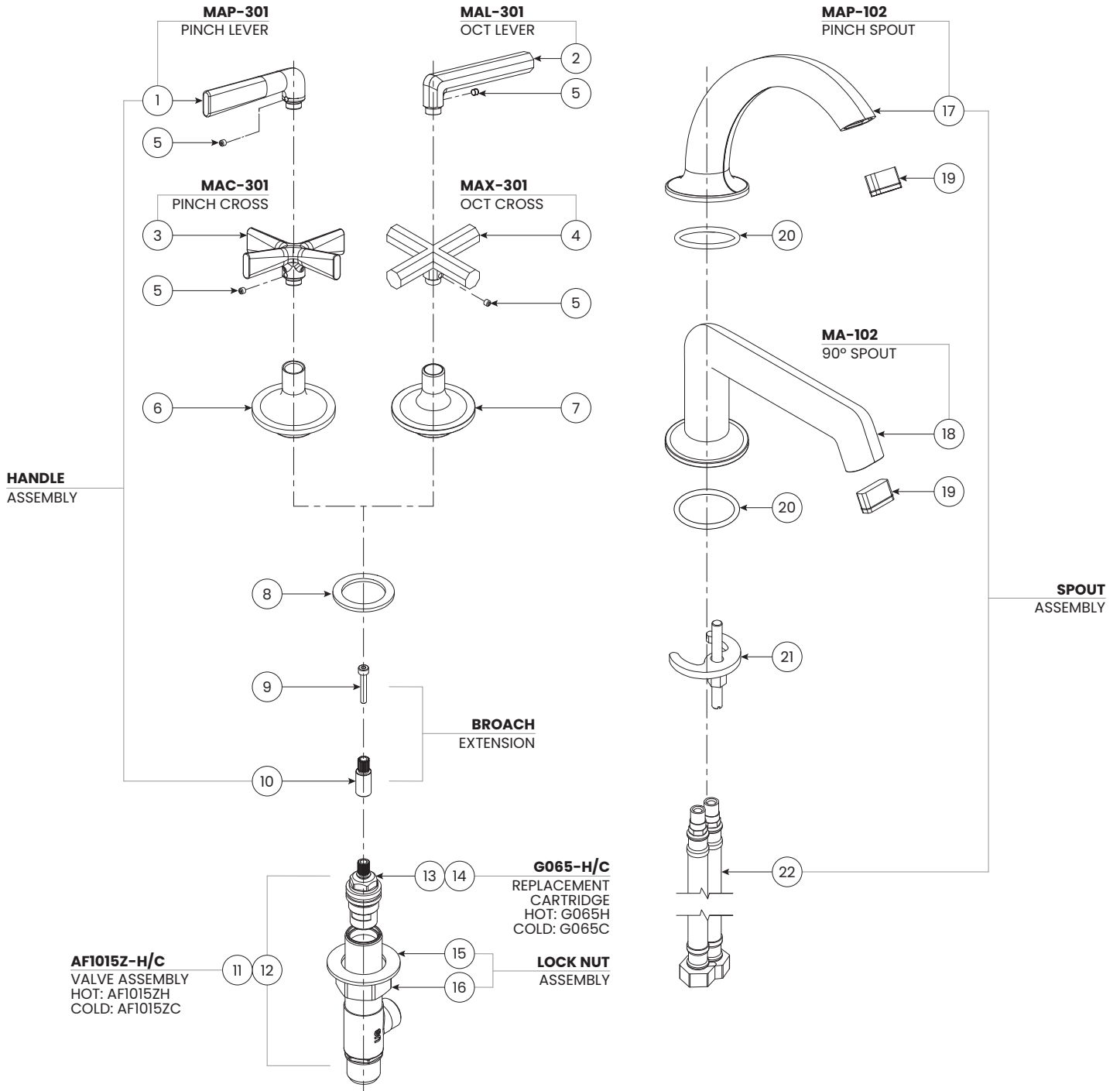



<b>MA-100 REPLACEMENT PARTS</b>			
<b>DESCRIPTION</b>	<b>PART NUMBER</b>	<b>FINISH REQUIRED</b>	<b>PARTS INCLUDED</b>
PINCH LEVER HANDLE ONLY	MAP-301-HDL	✓	1, 5
OCTAGONAL LEVER HANDLE ONLY	MAL-301-HDL	✓	2, 5
PINCH CROSS HANDLE ONLY	MAC-301-HDL	✓	3, 5
OCTAGONAL CROSS HANDLE ONLY	MAX-301-HDL	✓	4, 5
HANDLE BASE FOR PINCH HANDLES	MAP-301-BASE	✓	6, 8
HANDLE BASE FOR OCTAGONAL HANDLES	MA-301-BASE	✓	7, 8
BROACH EXTENSION SCREW	995-000049		9
BROACH EXTENSION	100-000103		10
LOCK NUT	LN-DV-05		15,16
1/2" CARTRIDGE, HOT	G065H		13
1/2" CARTRIDGE, COLD	G065C		14
AERATOR	070-000046		19
AERATOR REMOVAL KEY (NOT SHOWN)	A9Z50400-001		-
SPOUT O-RING	990-000072		20
SPOUT MOUNTING HARDWARE	105-000003		21
FLEXIBLE HOSE, (1 EACH)	100-000037		22
SET SCREW (M4X3)	995-000016		5
1/2" VALVE ASSEMBLY, HOT, COMPLETE	AF1015ZH		11 (13, 15, 16)
1/2" VALVE ASSEMBLY, COLD, COMPLETE	AF1015ZC		12 (14, 15, 16)
PINCH LEVER HANDLE ASSEMBLY, COMPLETE	MAP-301	✓	1, 5, 6, 8, 9, 10
OCTAGONAL LEVER HANDLE ASSEMBLY, COMPLETE	MAL-301	✓	2, 5, 6, 8, 9, 10
PINCH CROSS HANDLE ASSEMBLY, COMPLETE	MAC-301	✓	3, 5, 6, 8, 9, 10
OCTAGONAL CROSS HANDLE ASSEMBLY, COMPLETE	MAX-301	✓	4, 5, 6, 8, 9, 10
MA PINCH LAV SPOUT ASSEMBLY, COMPLETE	MAP-102	✓	17, 19, 20, 21, 22
MA 90° SPOUT ASSEMBLY, COMPLETE	MA-102	✓	18, 19, 20, 21, 22



MA-100 DECK MOUNTED 3-HOLE LAV FAUCET  
Mounting Specifications

